

Commissioning Connected Lighting



- 1) Setting up projects and networks
- 2) Setting up groups
- 3) Neighbor groups
- 4) Adding a product to a group
- 5) Resetting a product
- 6) Firmware update
- 7) Adding users to the project
- 8) Joining a project

Advanced settings

- 9) Product/group settings
- 10) Neighbor groups detailed
- 11) Time schedule
- 12) Recommended settings

Commissioning Connected Lighting

1) Setting up projects and networks



Open Steinel Connect App, select „Project setup“	Register to save projects in the cloud	Select “Create project”	Name the project	Select „+“, select „Create network“
--	--	-------------------------	------------------	-------------------------------------

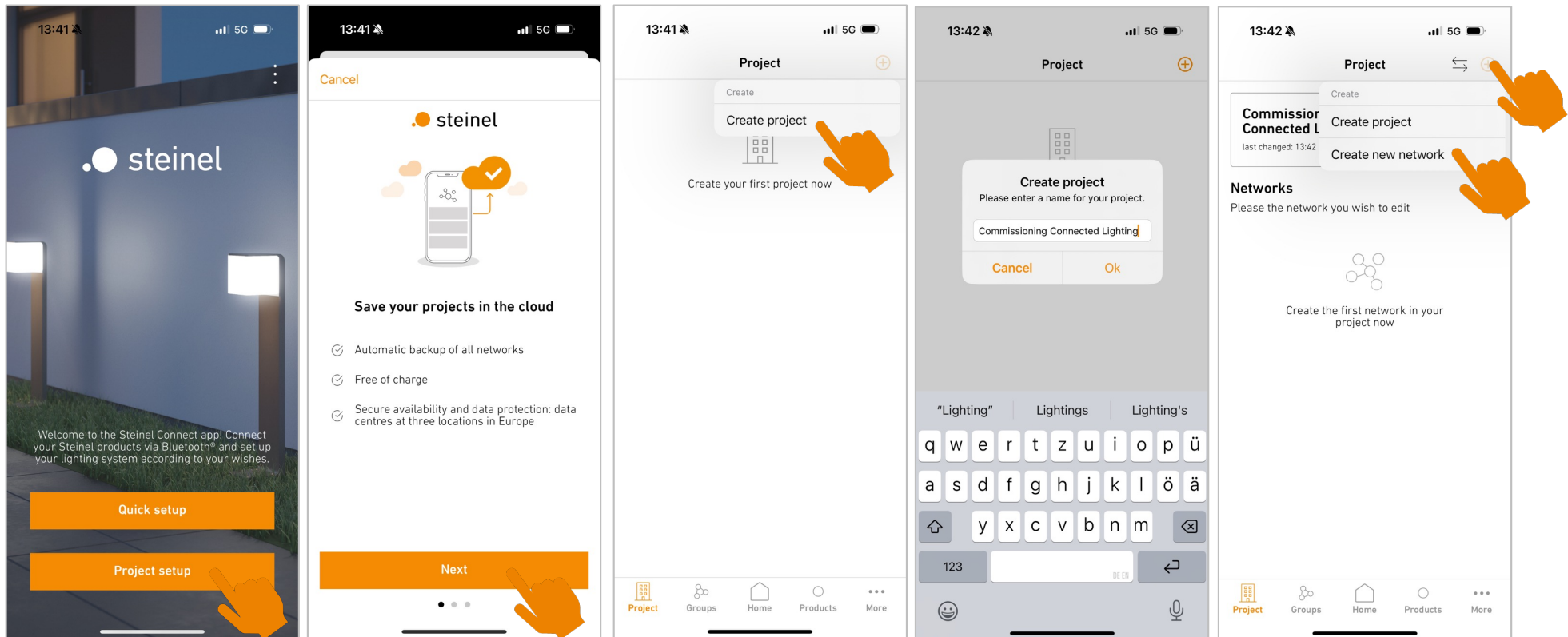

Commissioning Connected Lighting

1) Setting up projects and networks

Select „Create new network“	Name the network
--------------------------------	------------------

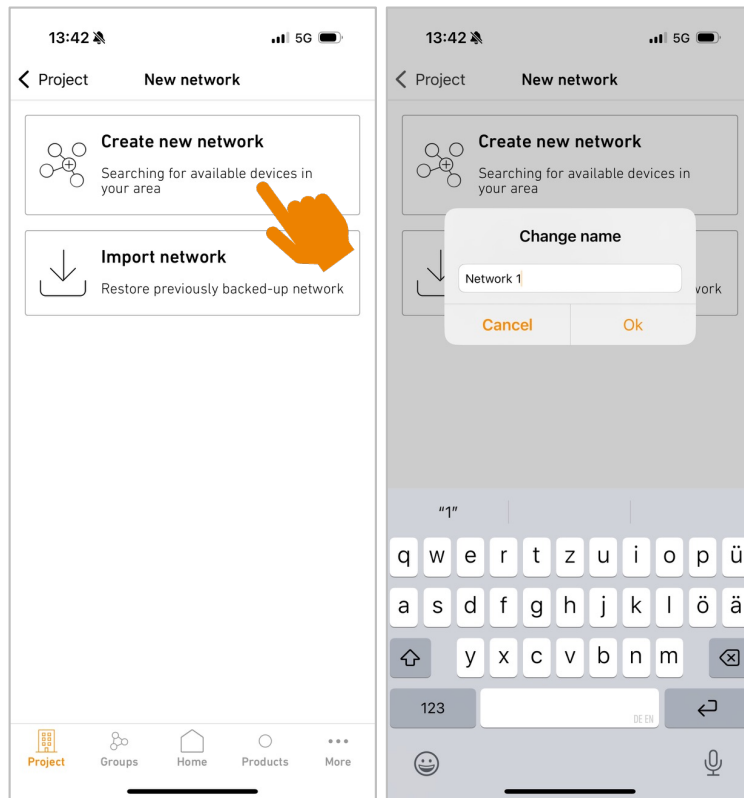

Commissioning Connected Lighting

2) Setting up groups

<p>Select "Groups", select "+" to create a new group</p>	<p>Name the group</p>	<p>Setup the group settings (detailed guide at section 9)</p>
--	-----------------------	---

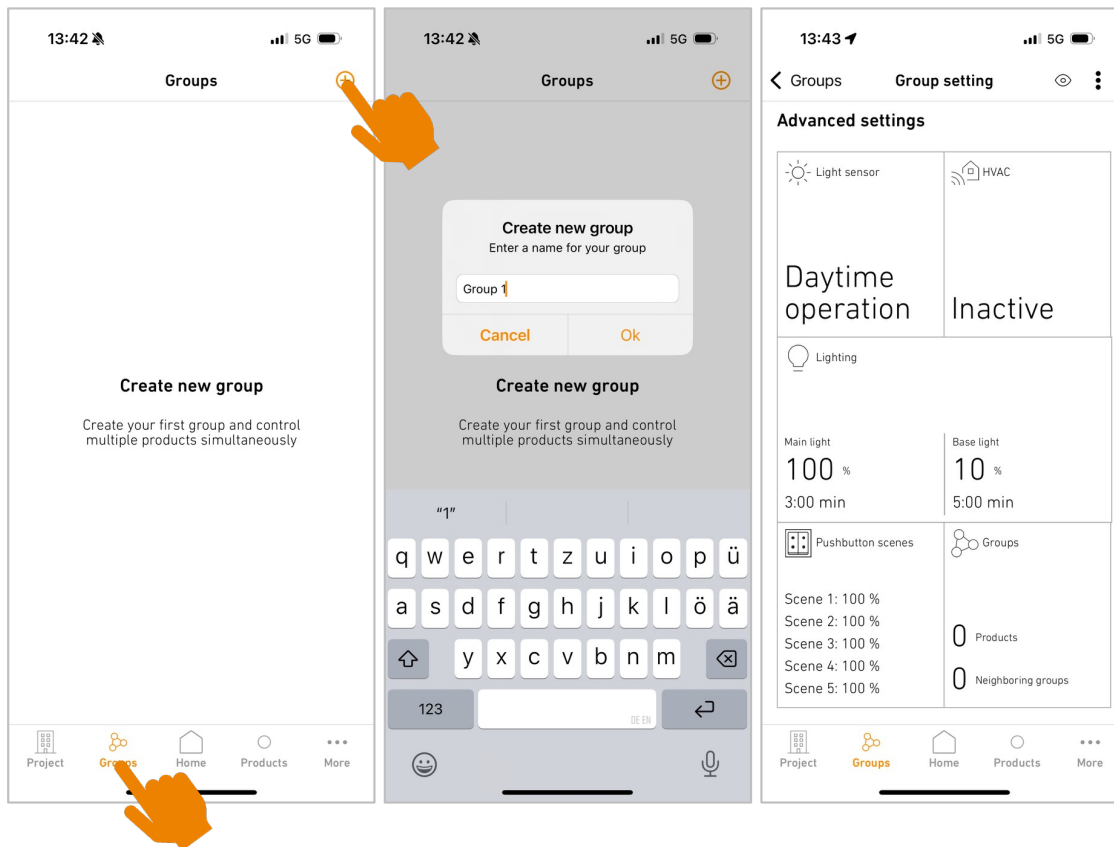

Commissioning Connected Lighting

3) Neighbor groups

Select "Groups"	Select „Neighboring groups“	Select „Neighboring groups“	Select „+“ to choose the neighboring group
-----------------	-----------------------------	-----------------------------	--

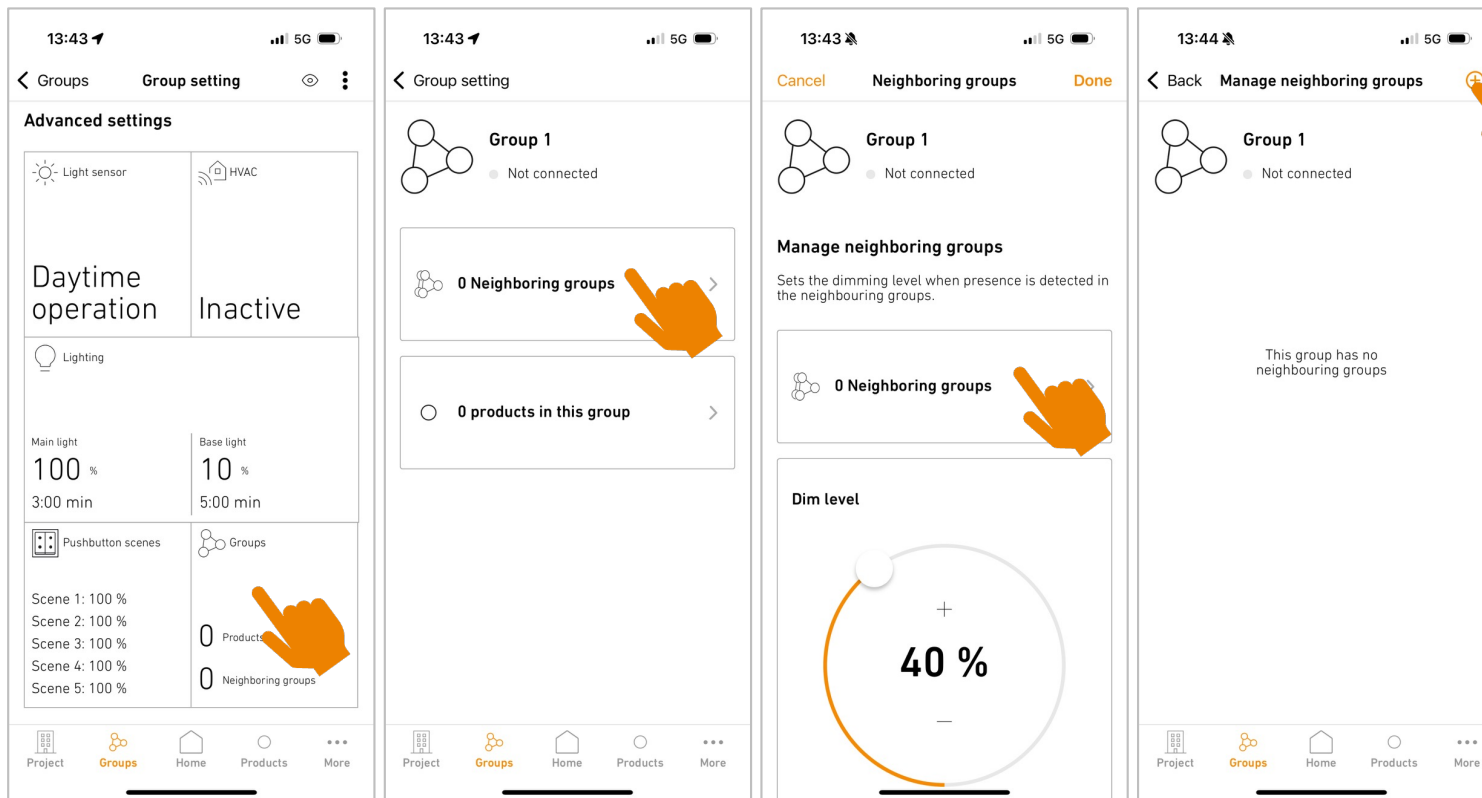

You will find a detailed guide on how to setup neighboring groups at section 10)

Commissioning Connected Lighting

4) Adding a product to a group

Select „Home“, select „Add product to group“

Choose the group in which you want to add the product

Choose the product you want to add to the group

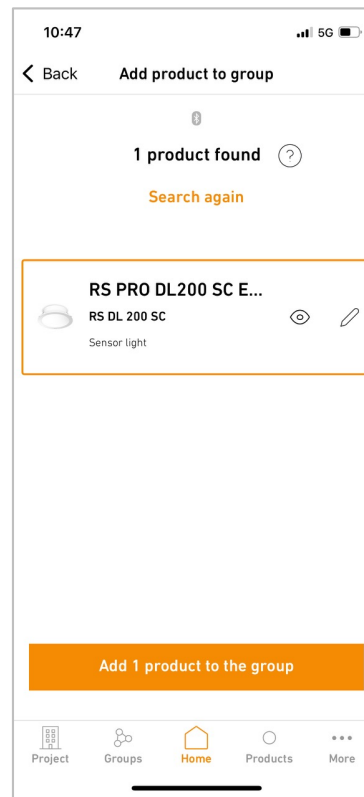
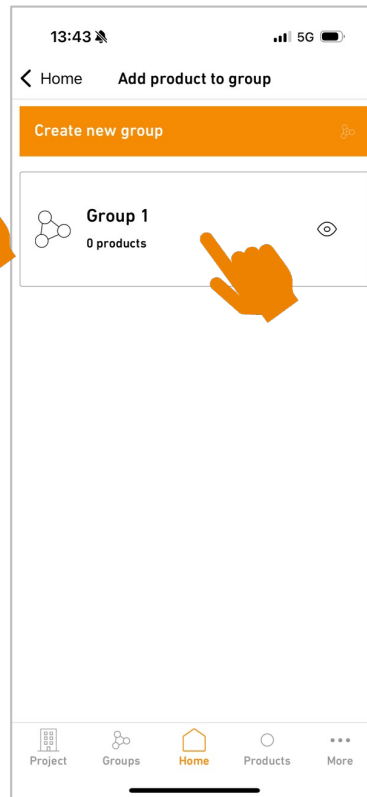
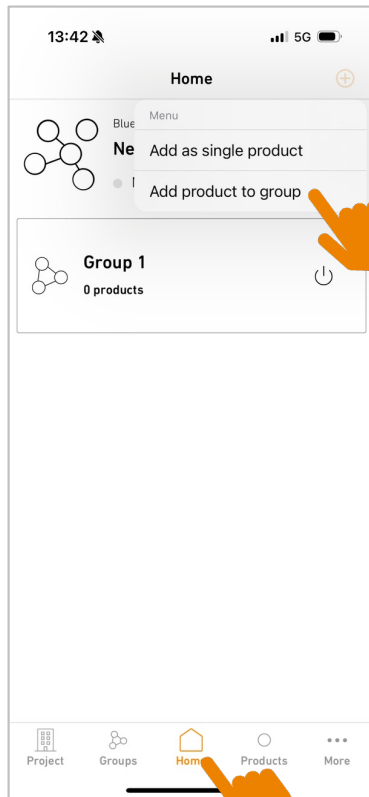

Commissioning Connected Lighting

5) Resetting a product

Cut off powersupply for 10 seconds	Select „More“, select „Reset product“	Select „Select device to reset“	Select the product you want to reset	Select „Reset product“
------------------------------------	---------------------------------------	---------------------------------	--------------------------------------	------------------------

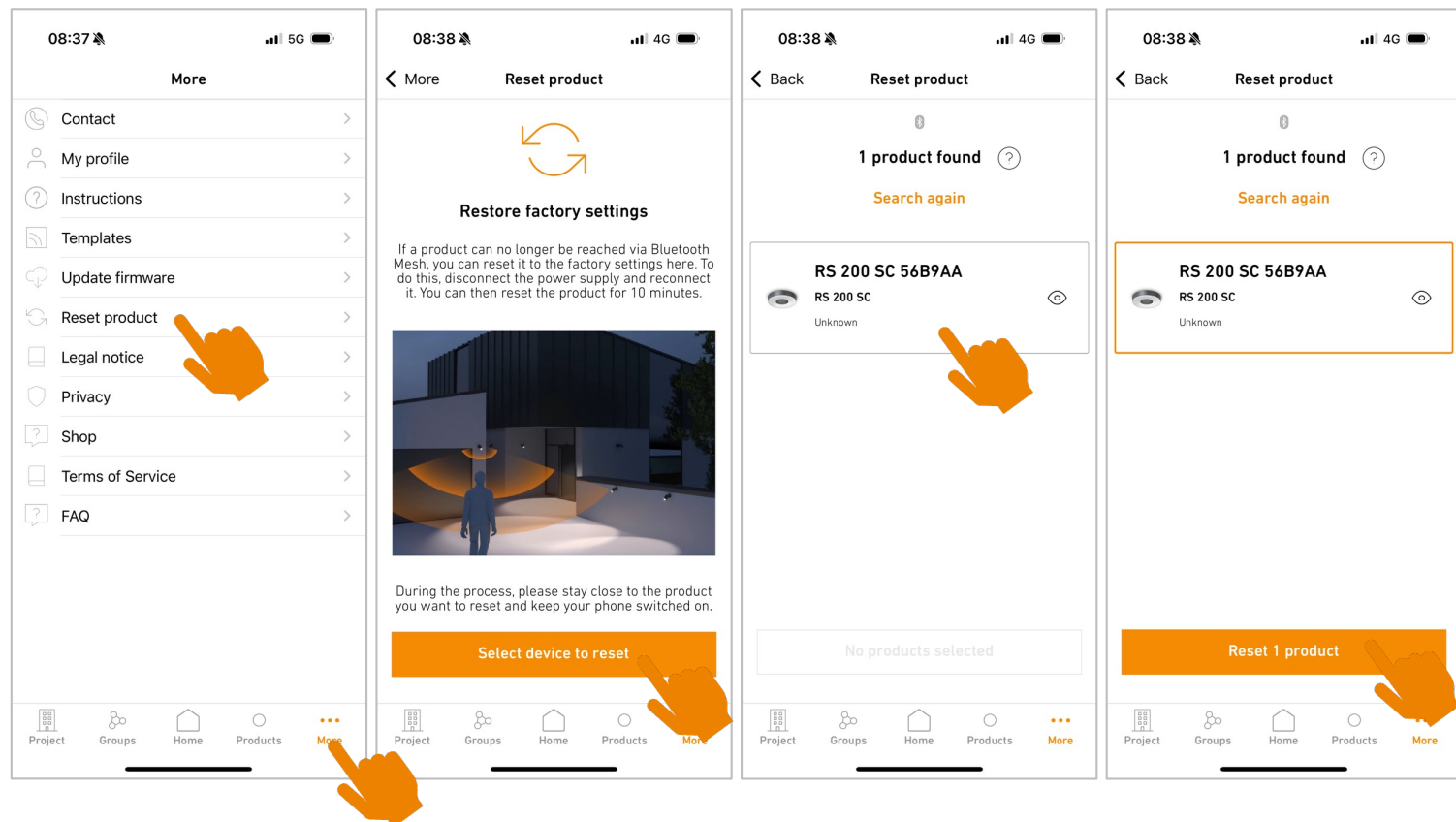

Commissioning Connected Lighting

6) Firmware update

Select "More", select "Update firmware"	Select „Select products“	If there is a product to update, select it and select „Update firmware“
---	--------------------------	---

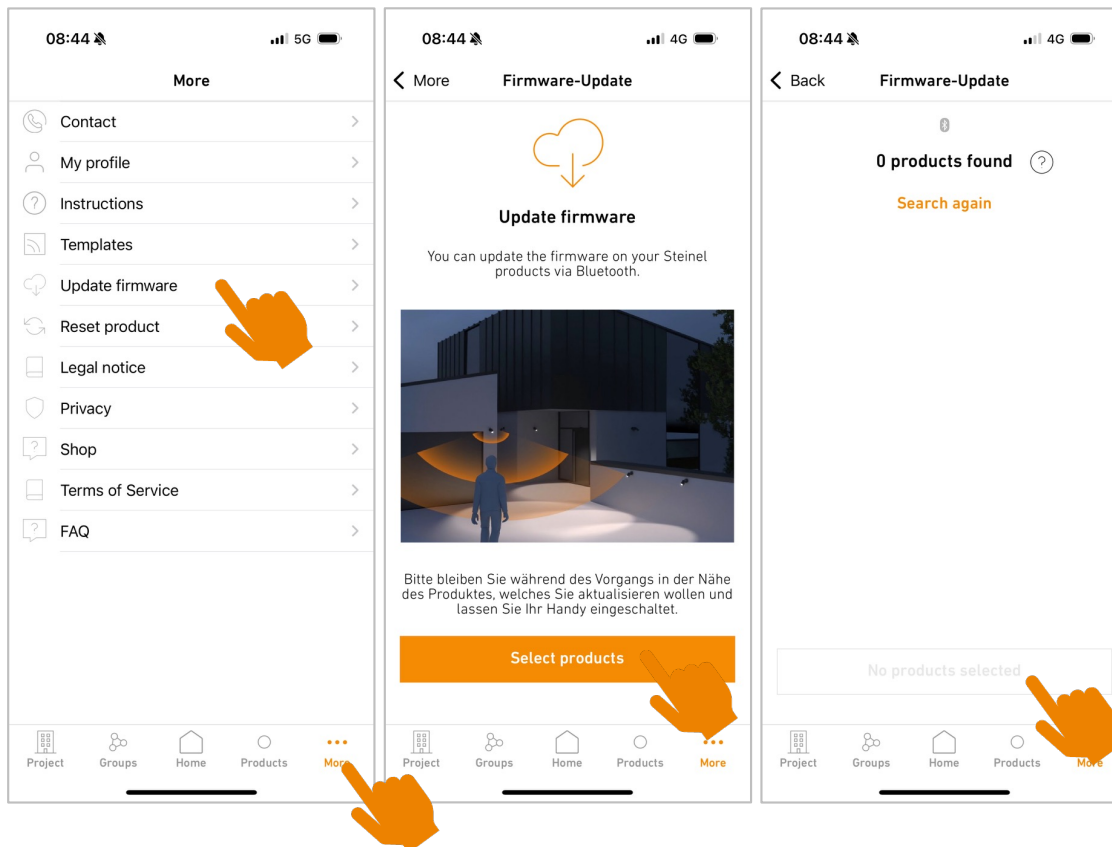

Commissioning Connected Lighting

7) Adding users to the project

Go into the project settings	Select „users“	Select “add user”	Select which type of user you want to add	Share invitation via text or mail or the user can scan the QR Code
------------------------------	----------------	-------------------	---	--

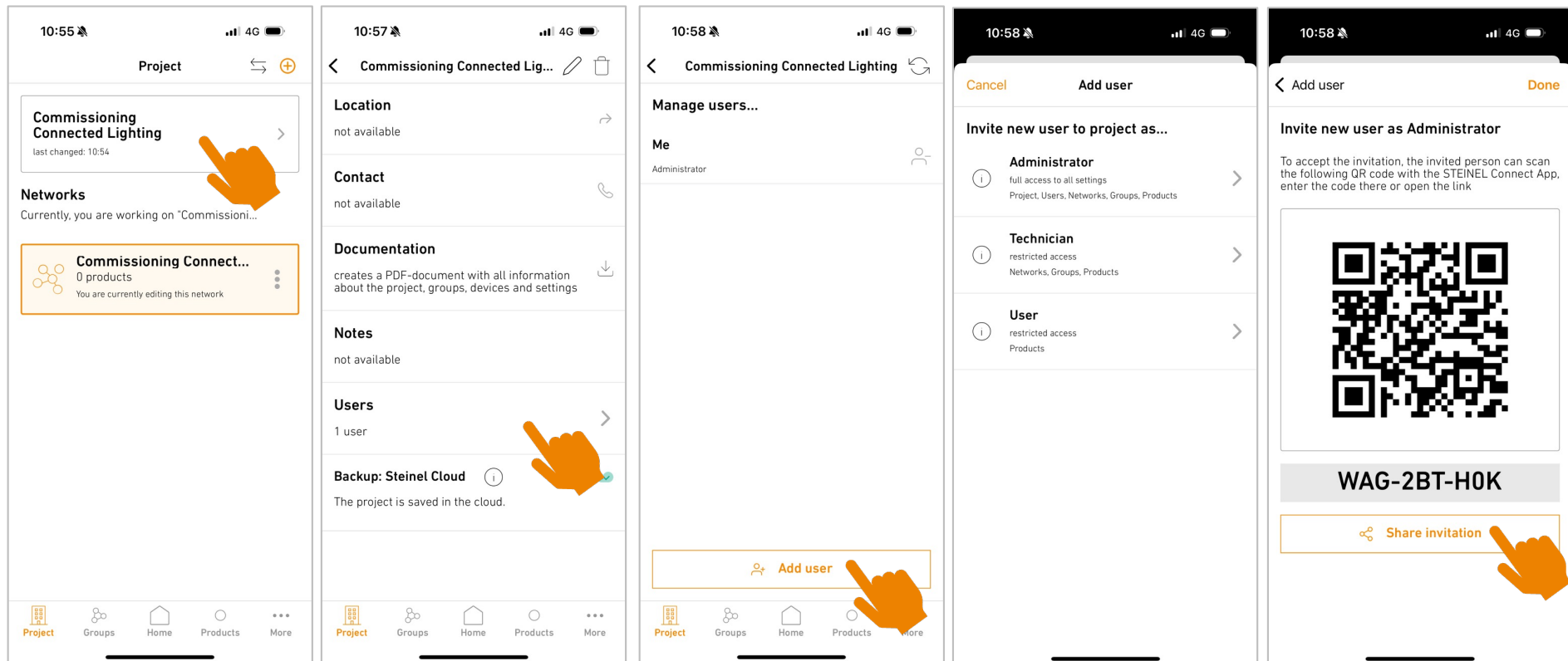

Commissioning Connected Lighting

8) Joining a project

Go into Projects overview	Select „join project“	Scan QR code or enter invitation code
---------------------------	-----------------------	---------------------------------------

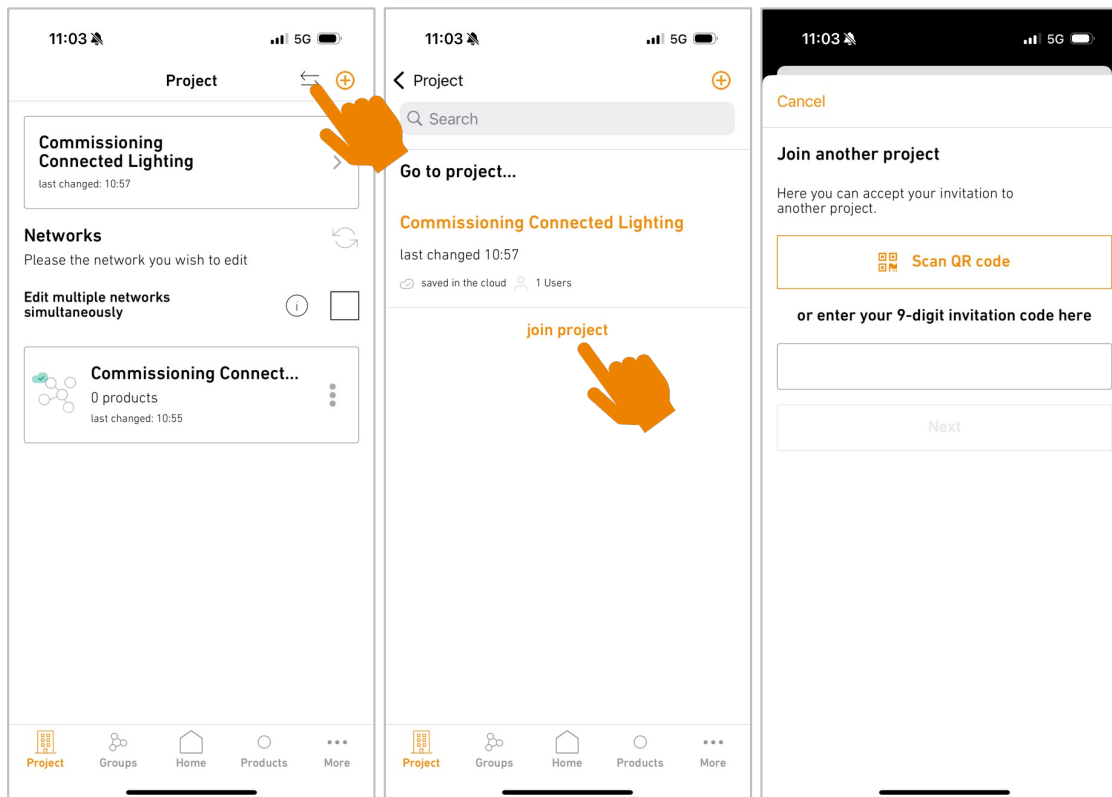

Advanced settings

Commissioning Connected Lighting

9) Settings

Select the pen symbol to change the name	Change the name	Select "Motion detector"	Change detection range by moving white circle	Setup the light sensor (if the product is in a group -> group settings)
--	-----------------	--------------------------	---	---

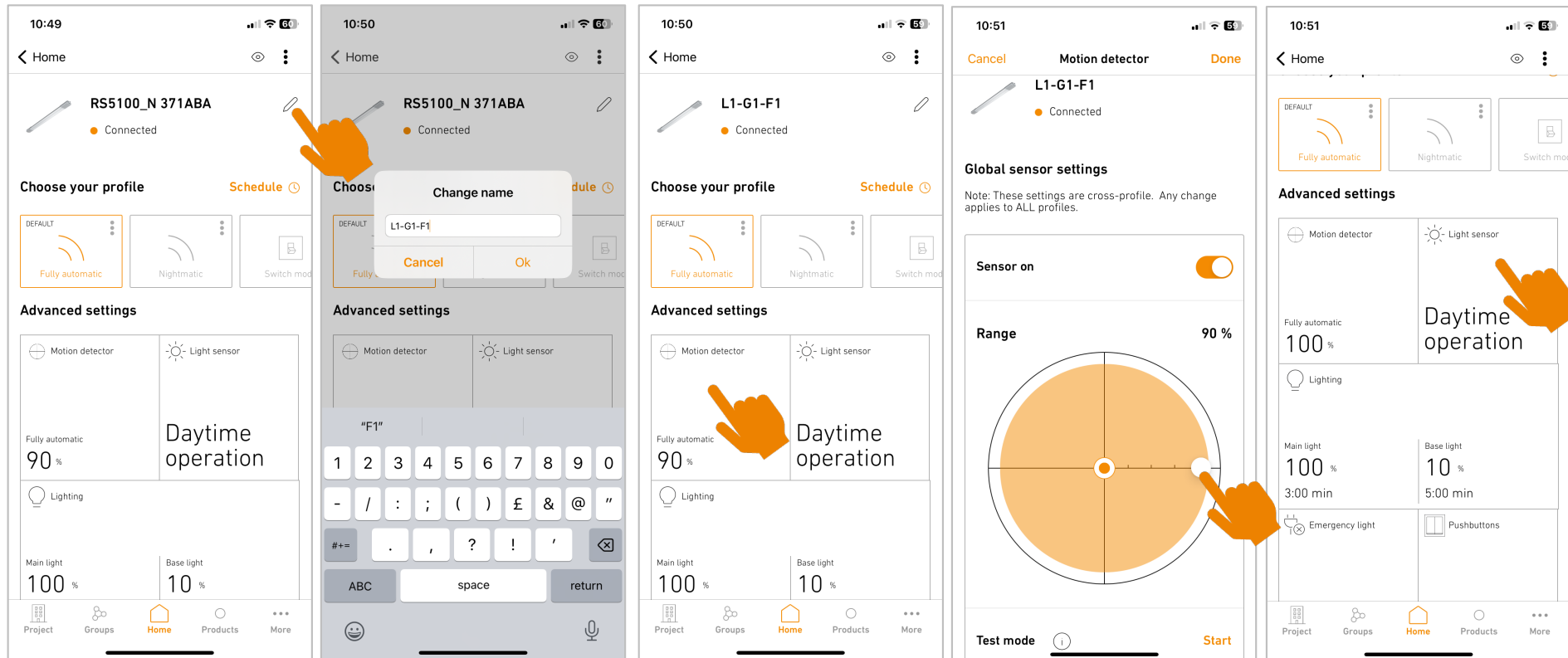

Commissioning Connected Lighting

9) Settings

<p>Select „Daytime operation“ to set the lux level where lights will turn off if daylight levels are above that level</p>	<p>Input the lux level above which the lights should turn off</p>	<p>If you don't want a specific lux level to switch the lights just ramp up the lux levels to the "sun" image</p>	<p>Select „Lighting“ to adjust the lighting settings</p>	<p>Move the white circle around the orange band to set the main light from 0-100%</p>
---	---	---	--	---

The screenshots illustrate the following steps:

- Step 1:** The 'Daytime operation' slider is moved to the right, indicated by an orange hand icon.
- Step 2:** A 'Brightness value' dialog box is shown with the value '100' entered, and an orange hand icon pointing to the 'Ok' button.
- Step 3:** The 'Brightness value' is set to '100 Lux', with an orange hand icon pointing to the slider.
- Step 4:** The 'Lighting' settings are shown, with an orange hand icon pointing to the 'Main light' percentage (100%).
- Step 5:** The 'Main light' dim level is set to '100%' using a circular slider, with an orange hand icon pointing to the white circle.

Commissioning Connected Lighting

9) Settings



<p>Select the drop down box with „3:00 min“ to set the time the main light stays on after no movement is detected</p>	<p>Choose the time you want the light to stay on for</p>	<p>This fade function is provided so that a sudden “on” or “off” doesn’t startle some users of the room</p>	<p>Adjust the fade times via the drop down boxes against each option</p>	<p>Basic light is the output the main light drops down to when no one has been detected for the preset time</p>
---	--	---	--	---

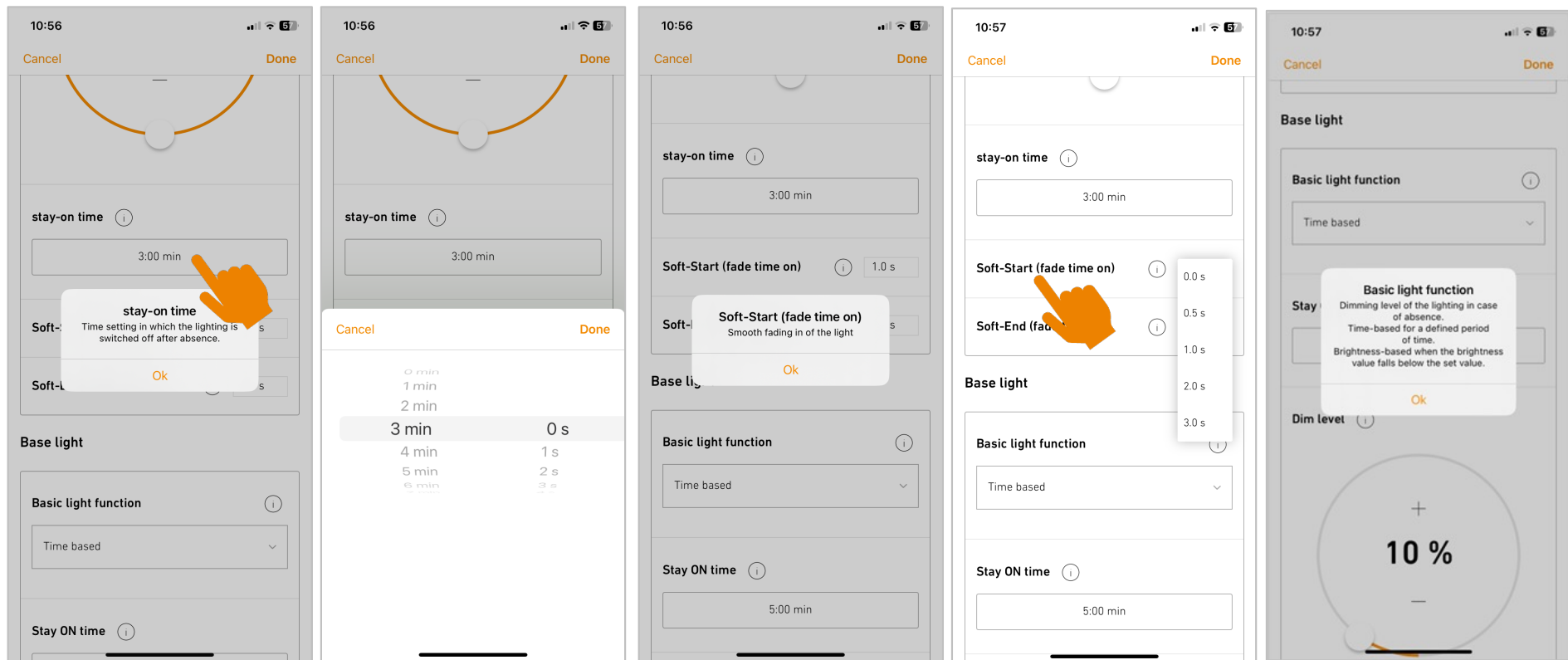

Commissioning Connected Lighting

9) Settings

Open the drop down
Off – no basic light
Time based – set a time
Brightness based -
same as lux level
settings

Select the drop down
box with „5:00 min“ to
set the time the basic
light stays on

Choose the time you
want the light to stay
on for

Move the white circle
around the orange
band to set the basic
light from 0-100%

Once finished setting
everything up the start
set up screen can be
seen.
Review the updated
settings to ensure they
are correct.

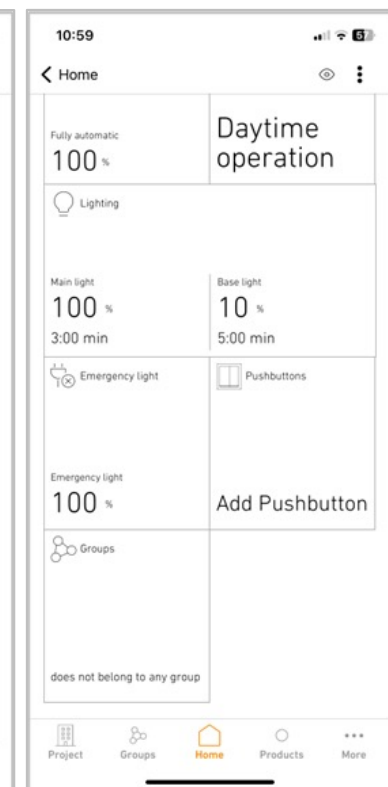
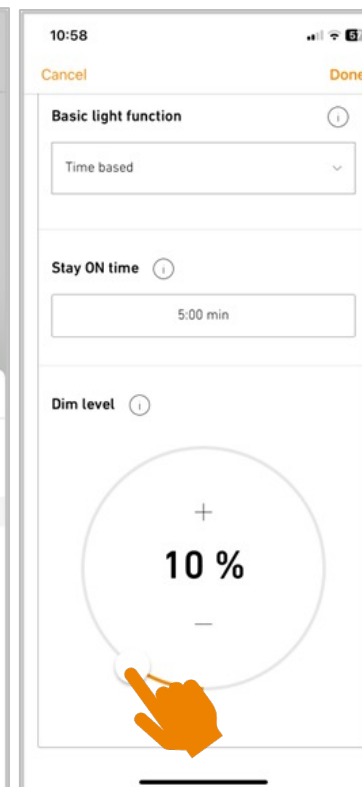
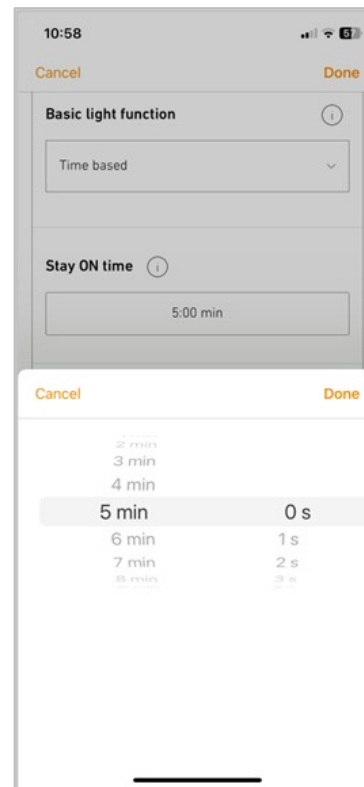
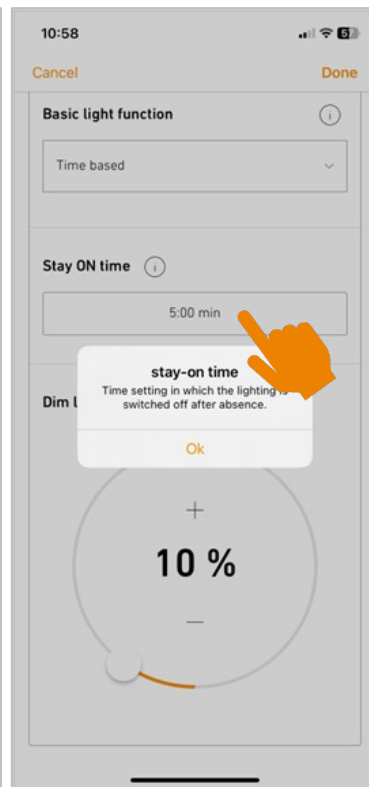
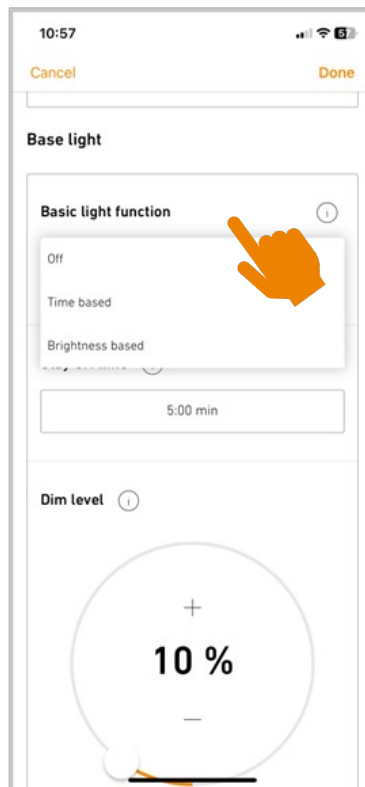

Commissioning Connected Lighting

10) Neighbor Groups

Select "Groups", select your first group you want to neighbor	Select "Groups"	Select „Neighboring groups“	Select „Neighboring groups“	Press „+“
---	-----------------	-----------------------------	-----------------------------	-----------

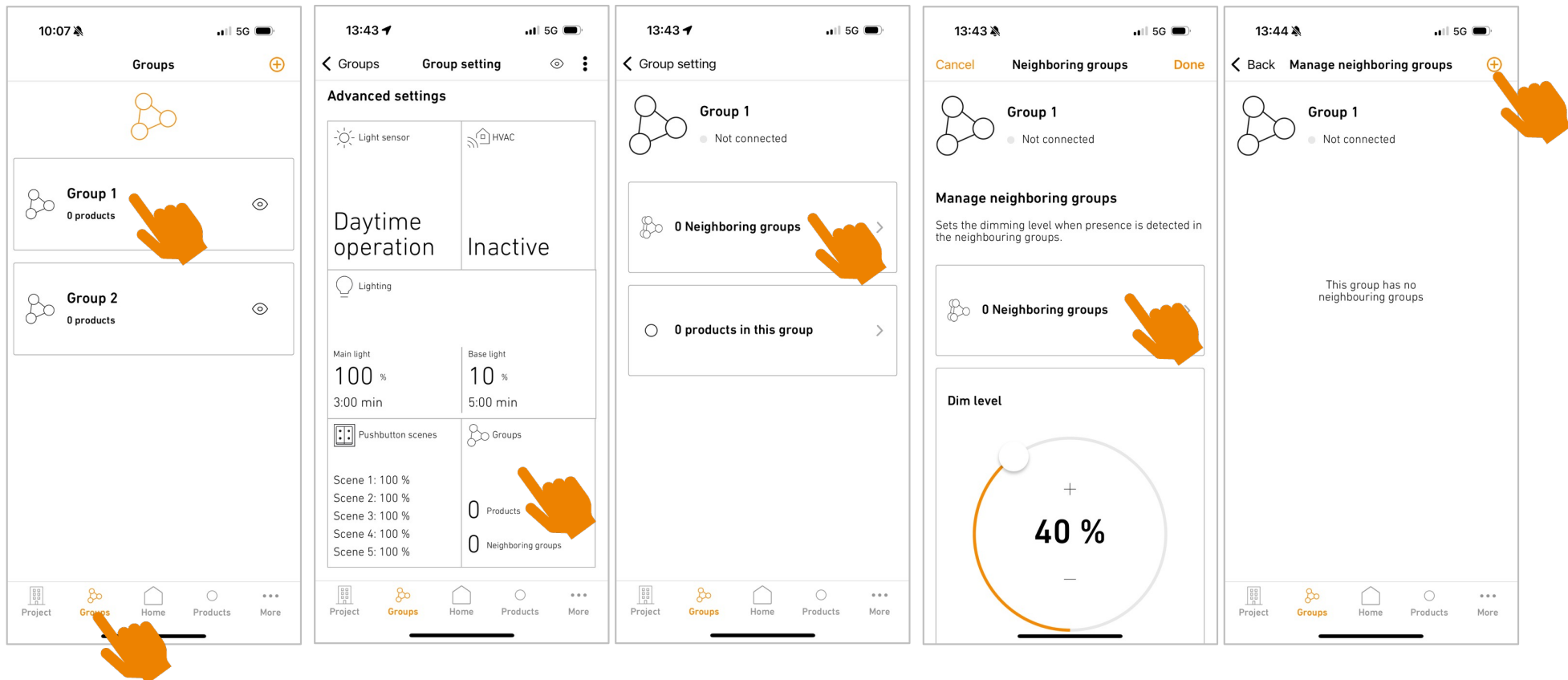

The screenshots illustrate the following steps:

- Step 1:** The 'Groups' screen shows two groups. An orange hand icon points to 'Group 1'.
- Step 2:** The 'Group setting' screen for Group 1 is shown. An orange hand icon points to the 'Neighboring groups' option under 'Advanced settings'.
- Step 3:** The 'Group setting' screen shows '0 Neighboring groups'. An orange hand icon points to the right arrow next to this text.
- Step 4:** The 'Neighboring groups' screen shows '0 Neighboring groups'. An orange hand icon points to the right arrow next to this text.
- Step 5:** The 'Manage neighboring groups' screen shows a '+' button in the top right corner. An orange hand icon points to this button.

Commissioning Connected Lighting

10) Neighbor Groups

<p>Choose the group you want as a neighboring group, press "Add as neighboring group"</p>	<p>Select "Groups"</p>	<p>Select „Neighboring group“</p>	<p>Set the dim level at which the group switches on when the neighboring group detects movement</p>	<p>Go to section „Groups“, select the group you neighbored to the first group</p>
---	------------------------	-----------------------------------	---	---

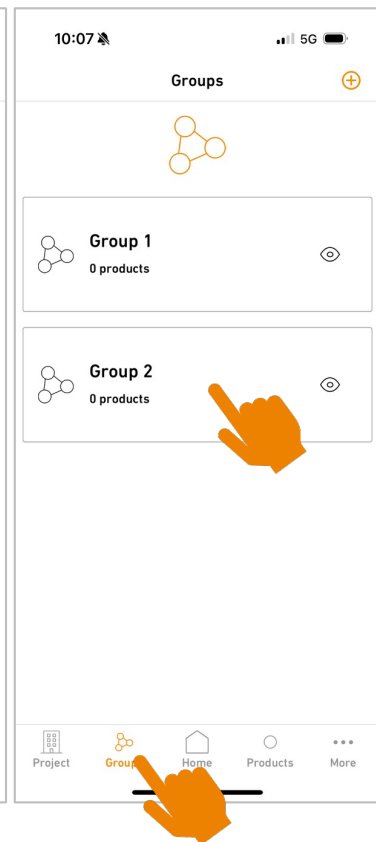
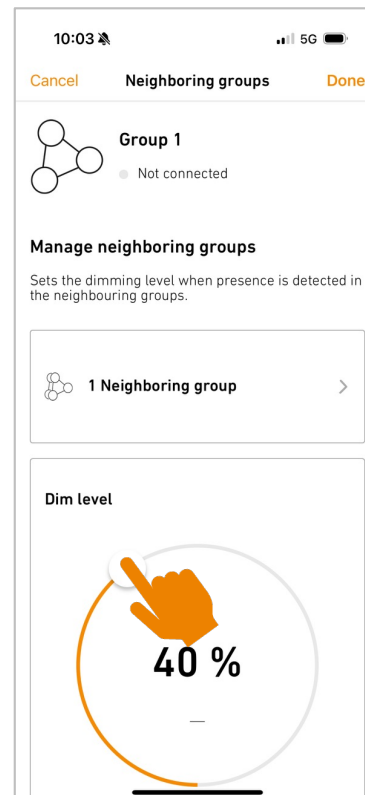
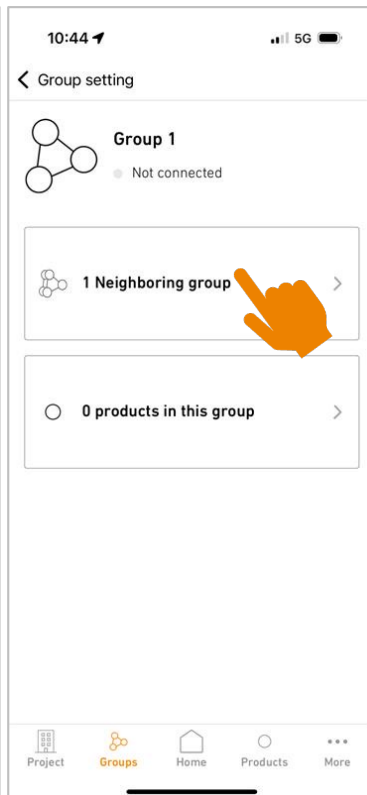
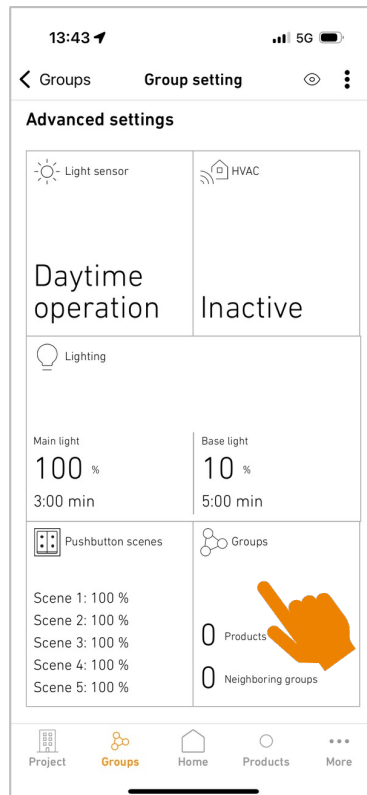
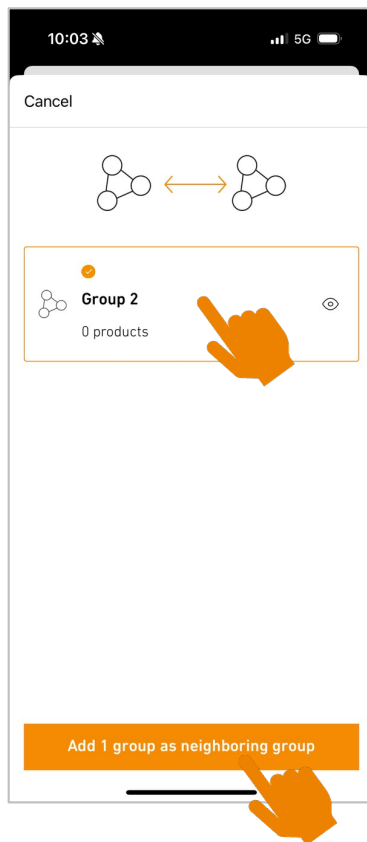

Commissioning Connected Lighting

10) Neighbor Groups

Select "Groups"	Select "Neighboring groups"	Select „Neighboring groups“	Press „+“	Choose the group you want as a neighboring group, press "Add as neighboring group"
-----------------	-----------------------------	-----------------------------	-----------	--

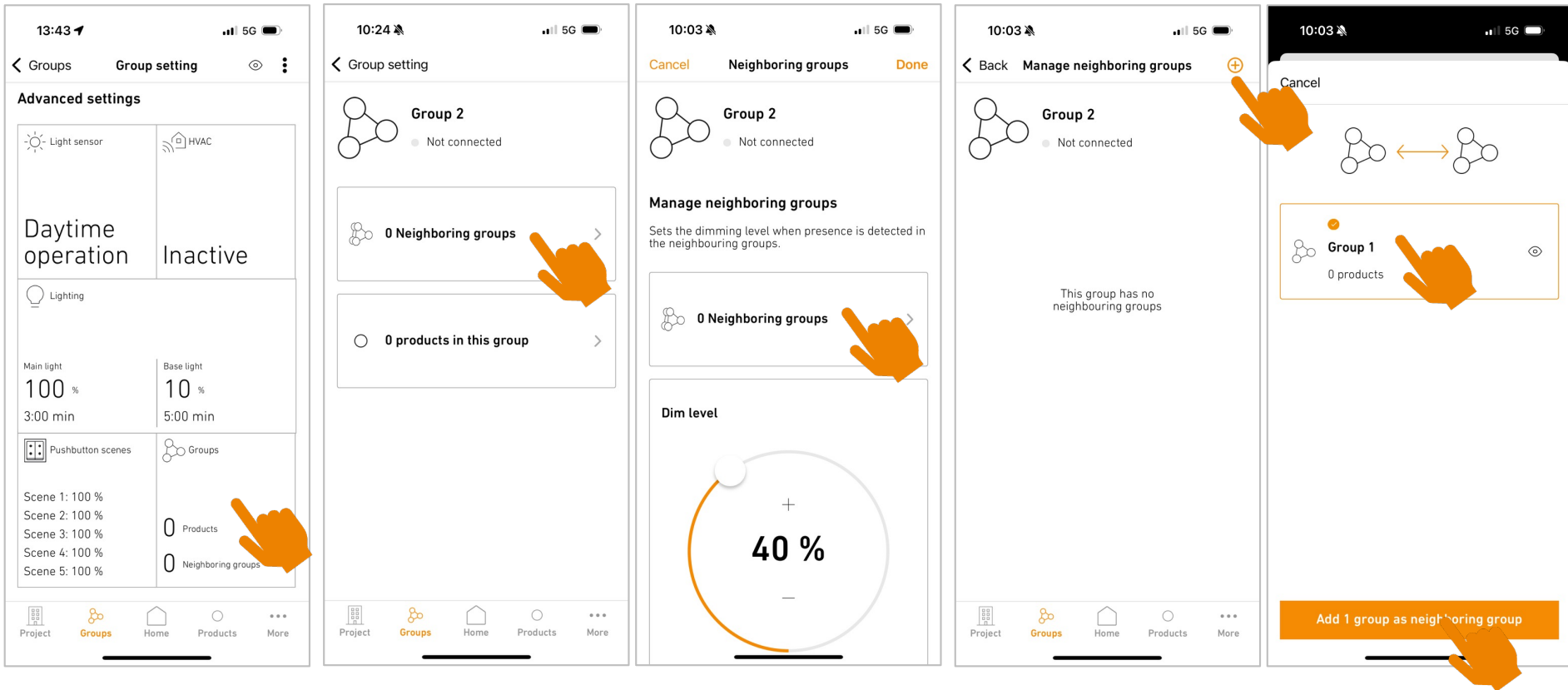

Commissioning Connected Lighting

10) Neighbor Groups

Select "Groups"	Select „Neighboring group“	Set the dim level at which the group switches on when the neighboring group detects movement
-----------------	----------------------------	--

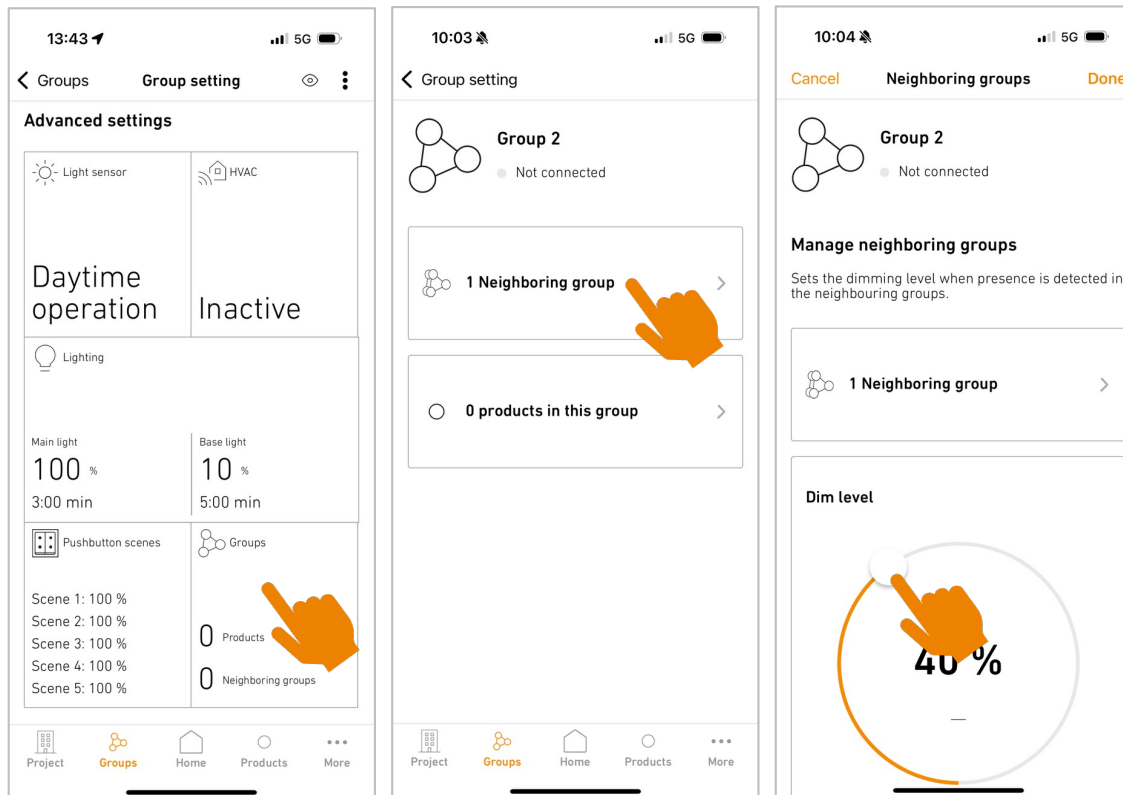

Now you are all set with the neighbor groups. When one group detects movement the other group will switch on at the set dim level.

Commissioning Connected Lighting

11) Time schedule

Go into group settings, select "Schedule"	Select "+"	Select scene and days and time when the scene should be active, then save	Example for another schedule	Overview of your schedules
---	------------	---	------------------------------	----------------------------

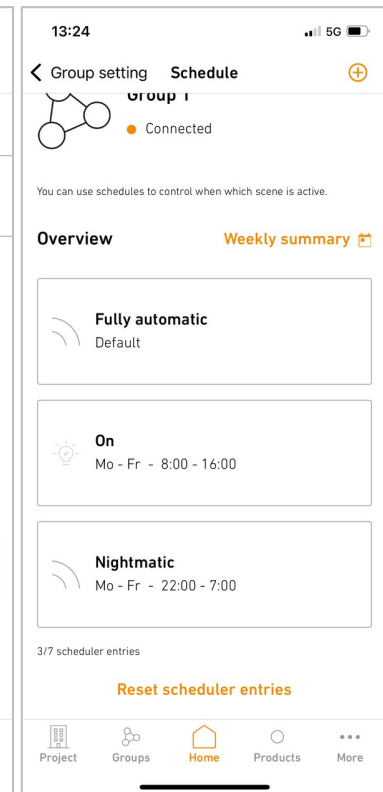
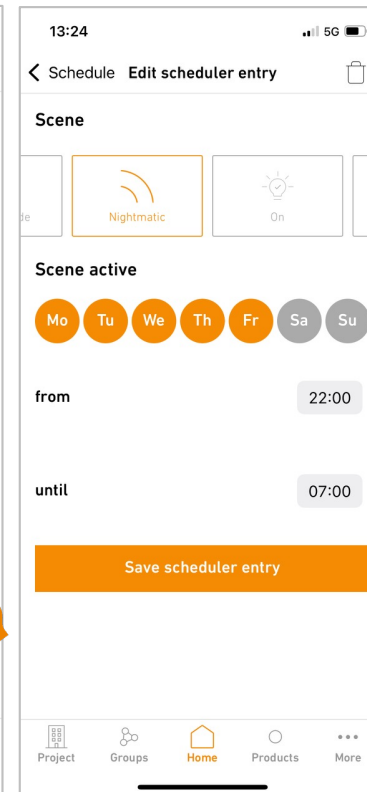
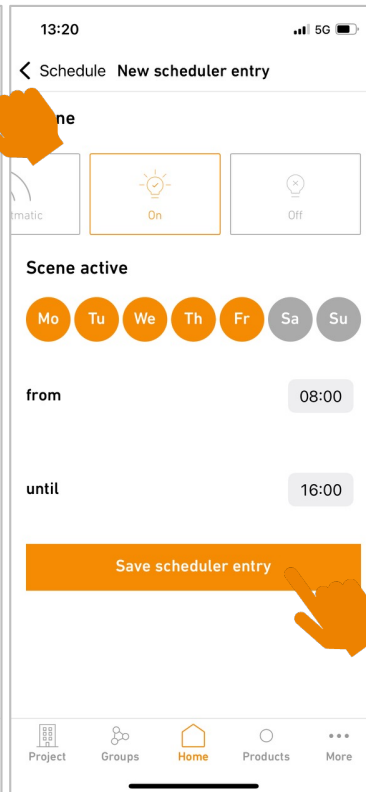
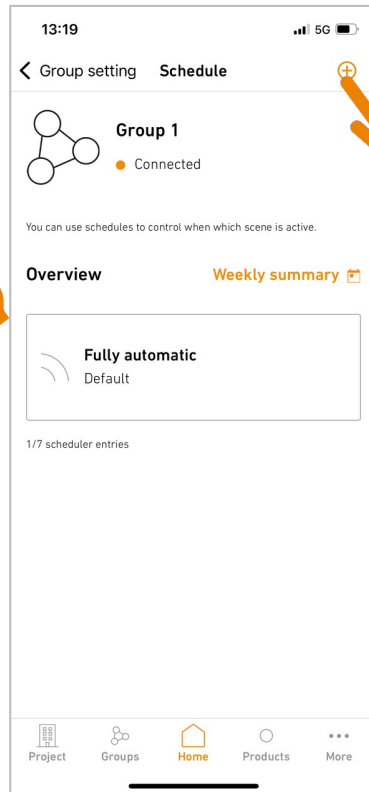
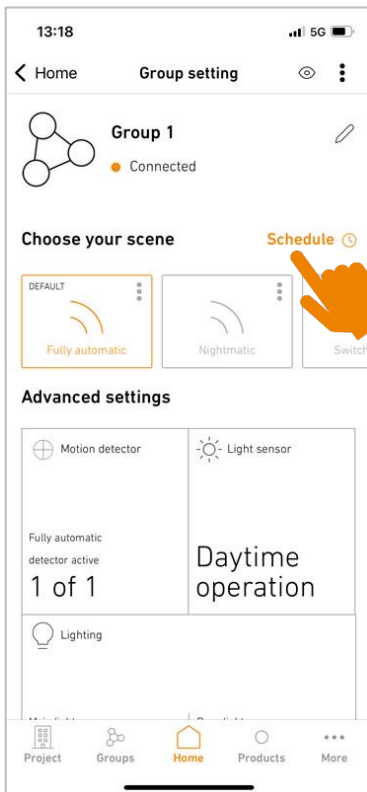

Commissioning Connected Lighting

12) Recommended settings

Choose your networks logically to minimize Bluetooth interruptions
(for example, car park: 1 network = 1 level)

Recommended group settings for staircases:

Main light: 100%, 1:00 min stay-on time, Soft-start 1 sec, Soft-end 3 sec

Base light: 10%, 30 sec stay-on time

Sensor: 50% range

Recommended groups settings for parking garages:

Main light: 100%, 1:30 min stay-on time, Soft-start 1 sec, Soft-end 3 sec

Base light: 10%, 1:00 min stay-on time

Sensor: 90% range

we invent